

# INTERMAT

16-21 APRIL 2012

PARIS-NORD VILLEPINTE  
EXHIBITION CENTRE, FRANCE

## SPECIAL OFFERS

4%\* saving if you book  
before 29 March 2011

Loyalty discount for  
2009 exhibitors



## REGISTRATION APPLICATION FORMS

### To register:

- **Online: Save time – from September 2010 register online at [www.intermat.fr](http://www.intermat.fr)**  
**NEW** for 2009 exhibitors: Your company's contact details are already completed.  
You can be sure you won't miss anything as any compulsory fields you forget to fill in will be highlighted.  
**Plus the online system calculates all the costs for you automatically.**
- **By post:** complete these forms and send them to us at:  
SE INTERMAT - Immeuble Wilson - 70, avenue du Général de Gaulle - 92058 Paris La Défense Cedex - FRANCE
- **By fax:** + 33 (0)1 53 30 95 36

**Registration closing date: 2 January 2012**  
**After this date, please contact us.**

### YOUR SALES CONTACTS:

**Véronique ARNAL**

Tel: +33 (0)1 76 77 11 27  
[veronique.arnal@comexposium.com](mailto:veronique.arnal@comexposium.com)

**Katia KUKAWKA**

Tel: +33 (0)1 76 77 13 89  
[katia.kukawka@comexposium.com](mailto:katia.kukawka@comexposium.com)

**Delphine EMMA**

Tel: +33 (0)1 76 77 12 90  
[delphine.emma@comexposium.com](mailto:delphine.emma@comexposium.com)

Fax: +33 (0)1 53 30 95 36 • [www.intermat.fr](http://www.intermat.fr)

# INTERMAT



4%\* saving if  
you book before  
29 March 2011

## YOUR REGISTRATION

### You are a direct exhibitor:

- 1- Complete the general company information pages **3, 4, 5**
- 2- Book your stand space and choose your stand package
  - a- Book an outdoor stand: minimum area > 50m<sup>2</sup> page **6**
  - b- Book an indoor stand pages **8, 9**
- 3- Order your initial promotional media and finalise your registration pages **11, 12**

### You are a co-exhibitor:

- 1- Complete the general company information pages **3, 4, 5**
- 2- Order your initial promotional media and finalise your registration pages **11, 12**

### You will find all the Interamat 2012 registration forms in the appendices:

- Appendix 1** : List of equipment and technology exhibited
- Appendix 2** : Declaration of representation
- Appendix 3** : Terms & Conditions of space rental and stand fitting

## KEY DATES FOR EXHIBITORS

Your stand will be allocated according to your date of registration.  
Your preferences and location requests will be taken into account as far as possible, subject to availability.

### YOUR STAND:

- Today ▶ Complete your registration forms
- September 2010 ▶ Opening of online registration
- 29 March 2011 ▶ Deadline for discount: 4% saving on price of bare stand space
- June 2011 ▶ Confirmation of your stand site
- September 2011 ▶ Order additional services
- November 2011 ▶ Send your stand plan for approval (compulsory)

### PROMOTION:

- Today ▶ Order promotional tools
- September 2010 ▶ Registration for the Interamat Innovation Awards  
Closing date: September 2011  
The global innovation showcase  
Present your innovations to the international press.
- September 2010 ▶ Registration for Pre-Interamat  
Closing date: October 2011  
Meet the international trade press over two days for one-on-one briefings.



Further information on these events and how to register for them can be found in Part 2 "PROMOTION"

\*On the price of the bare stand space



**YOUR COMPANY'S SENIOR MANAGERS**

**Managing Director**

Title  Mr  Mrs  Ms

Surname \_\_\_\_\_ First name \_\_\_\_\_

E-mail \_\_\_\_\_

**Sales Director**

Title  Mr  Mrs  Ms

Surname \_\_\_\_\_ First name \_\_\_\_\_

E-mail \_\_\_\_\_

**Marketing & Communications Director**

Title  Mr  Mrs  Ms

Surname \_\_\_\_\_ First name \_\_\_\_\_

E-mail \_\_\_\_\_

**Your presence internationally:**

CEO :  Mr  Mrs  Ms \_\_\_\_\_ E-mail \_\_\_\_\_

Export Director:  Mr  Mrs  Ms \_\_\_\_\_ E-mail \_\_\_\_\_

**Markets in which you are currently active or are developing**

INDIA  MIDDLE EAST  OTHER COUNTRIES/REGIONS \_\_\_\_\_

Contact :  Mr  Mrs  Ms \_\_\_\_\_ E-mail \_\_\_\_\_

**YOUR BUSINESS CATEGORY**

Manufacturer  Importer  Distributor

Equipment hire  Trade association  Other (please give details): \_\_\_\_\_

**YOUR ACTIVITY**

Please refer to **Appendix 1** "LIST OF EQUIPMENT AND TECHNOLOGY EXHIBITED" to find the relevant code number

Your main activity: \_\_\_\_\_ Other activities: \_\_\_\_\_

**YOUR SECTOR**

CIVIL ENGINEERING  CONSTRUCTION  CONSTRUCTION MATERIALS

**2 YOUR PARTNERS**

Two types of partners are permitted on an exhibitor's stand: co-exhibitors and represented companies.

**CO-EXHIBITORS**

I am an exhibitor and I will be hosting one or more co-exhibitor(s) on my stand

1- Company name \_\_\_\_\_ Country \_\_\_\_\_ Tel. \_\_\_\_\_

2- Company name \_\_\_\_\_ Country \_\_\_\_\_ Tel. \_\_\_\_\_

3- Company name \_\_\_\_\_ Country \_\_\_\_\_ Tel. \_\_\_\_\_

Each co-exhibitor must return a completed and signed registration application to the Organiser.

**REPRESENTED COMPANIES**

The applicant undertakes to supply a Declaration of Representation to each represented company

(see **Appendix 2**).

I declare that we are representing on our stand \_\_\_\_\_ company (companies) as listed below:

Company name, address, country, telephone, fax, e-mail, website	Legal relationship to applicant*	Activity**	FOR ORGANISER'S USE ONLY
		_____	_____
		_____	_____
		_____	_____
		_____	_____

\* (subsidiary, parent company, principal, distributor)

\*\* Refer to **Appendix 1** "LIST OF EQUIPMENT AND TECHNOLOGY EXHIBITED"

### 3 YOUR STAND

#### YOU CAN RESERVE AN INDOOR STAND AND/OR AN OUTDOOR STAND.

I wish to reserve:

- An **OUTDOOR** stand **PLEASE NOTE** minimum area 50 m<sup>2</sup>
- An **INDOOR** stand **PLEASE NOTE** The only options available for stands of 25 m<sup>2</sup> or under are **BASIC**, and **PACK PLUS**

#### EXHIBITION SECTOR

Please indicate below the exhibition sectors in which you would like to exhibit, ranking them 1 to 3 in order of preference:

- A** Earthmoving
- B** Roads
- ICEA** : INTERMAT COMPONENTS, EQUIPMENT & ACCESSORIES (please specify your sector below)
  - C** Components / Equipment / Accessories
  - D** Engines and applications
- E** Lifting / Handling
- F** Construction / Concrete / Scaffolding / Formwork
- G** Building site machinery, equipment and tools
- H** Materials processing / Mining & Quarrying
- I** Drilling / Boring / Compressors / Special foundations / Tunnels
- J** Transport
- K** Topography
- L** Equipment hire
- M** Engineering / New Technologies/ Services
- N** Press / Institutions and organisations
- O** Energy / Environment / Recycling

Does your company manufacture machinery and technology related to energy, the environment and/or recycling?  
If so, please specify (e.g. hybrid engines, electric motors, etc.)

---

---

---

#### DISPLAYING LARGE OR HEAVY EQUIPMENT

Please indicate below any physical constraints relating to the equipment you are exhibiting which we need to take into account when deciding your stand location:

- Very heavy equipment \_\_\_\_\_ kg
- Very tall equipment \_\_\_\_\_ metres
- Very long equipment \_\_\_\_\_ metres

Equipment displayed on your stand \_\_\_\_\_

---

---

If you have an existing stand structure, you **must** give details here: L \_\_\_\_\_ m x W \_\_\_\_\_ m

#### LOCATION OF YOUR STAND

Please indicate any preferences you may have which will help us to determine the best stand site for you (setting, adjacent exhibitors/facilities, etc.).  
**Confidential information.**

---

---

---

**Please note** Your stand will be allocated according to your date of registration. The preferences and constraints indicated above will be taken into account as far as possible, subject to availability.

#### LIST 5 OR MORE COMPANIES IN THE SAME BUSINESS SECTOR

1. \_\_\_\_\_
2. \_\_\_\_\_
3. \_\_\_\_\_
4. \_\_\_\_\_
5. \_\_\_\_\_

# A Stand located outside the exhibition halls

## BOOK YOUR STAND SPACE

I wish to apply for a stand of \_\_\_\_\_ m<sup>2</sup> (minimum 50 m<sup>2</sup> outdoor space)

With the following dimensions if possible: L \_\_\_\_\_ m x W \_\_\_\_\_ m

### 1 YOUR STAND AREA

Calculation for a stand of 1,000 m<sup>2</sup>: (200 m<sup>2</sup> x €123) + (600 m<sup>2</sup> x €111) + (200 m<sup>2</sup> x €87)

From 50 to 200 m<sup>2</sup>: \_\_\_\_\_ m<sup>2</sup> x **€123 excl. VAT** = € \_\_\_\_\_ excl. VAT **a**

From 201 to 800 m<sup>2</sup>: \_\_\_\_\_ m<sup>2</sup> x **€111 excl. VAT** = € \_\_\_\_\_ excl. VAT **b**

Over 800 m<sup>2</sup>: \_\_\_\_\_ m<sup>2</sup> x **€87 excl. VAT** = € \_\_\_\_\_ excl. VAT **c**

**SUBTOTAL (a + b + c)** = € \_\_\_\_\_ excl. VAT **1**

### 2 SUPPLEMENT FOR ADDITIONAL OPEN SIDES

Subject to site availability

**For stands < 800 m<sup>2</sup>**

Stand with  2 open sides: + 12%       3 open sides: + 17%       4 open sides: + 20%  
i.e. a supplement of: **1** x \_\_\_\_\_ % = € \_\_\_\_\_ excl. VAT **d**

**For a stand ≥ 800 m<sup>2</sup>**

Stand with  2 open sides: €9,960 excl. VAT     3 open sides: €14,940 excl. VAT     4 open sides: €17,920 excl. VAT = € \_\_\_\_\_ excl. VAT **e**

**SUBTOTAL exhibition space + additional open side(s): 1 + d or e** = € \_\_\_\_\_ excl. VAT **2**

Note: Your invoice will show the total amount for the bare stand space taking into account the supplement percentage corresponding to the number of open sides chosen.

### LOYALTY DISCOUNT for exhibitors present in 2009:

Total surface \_\_\_\_\_ m<sup>2</sup> x - **€7 excl. VAT** = € \_\_\_\_\_ excl. VAT **f**

**3**  I exhibited in 2009

**2 - f**

I am a new exhibitor

**2**

}

= € \_\_\_\_\_ excl. VAT **3**

### 4% saving

**SUBTOTAL 3 x 4%** = € \_\_\_\_\_ excl. VAT **g**

On the price of the bare stand space for all exhibitors registering by 29 March 2011 (applications must be postmarked on or before this date)

### 4 SUBTOTAL SPACE BOOKED

**(3 - g) or 3** = € \_\_\_\_\_ excl. VAT **4**

## CHOOSE YOUR STAND PACKAGE (optional)

Add the cost of the fitted stand to the total calculated above

### 5 PAGODA OR BUNGALOW – fixed price per module

Pagoda 25 m<sup>2</sup> - €4,134 excl. VAT

Pagoda 100 m<sup>2</sup> - Fixed price (on request)

Pagoda 50 m<sup>2</sup> - €7,314 excl. VAT

Bungalow 15 m<sup>2</sup> - €4,293 excl. VAT

No. of modules \_\_\_\_\_ x € \_\_\_\_\_ excl. VAT = € \_\_\_\_\_ excl. VAT **5**

### 6 ADDITIONAL OPTION FOR BARE OUTDOOR STAND

Cleaning (€3.50 excl. VAT/m<sup>2</sup>): \_\_\_\_\_ m<sup>2</sup> x €3,5 excl. VAT = € \_\_\_\_\_ excl. VAT **6**

### 7 SUBTOTAL STAND PACKAGE

**(5 + 6)** = € \_\_\_\_\_ excl. VAT **7**

## A TOTAL OUTDOOR STAND

**Space booked** = € \_\_\_\_\_ excl. VAT **4**

**Intermat stand package** + € \_\_\_\_\_ excl. VAT **7**

**TOTAL OUTDOOR STAND** = € \_\_\_\_\_ excl. VAT **A**

# Outdoor stand packages

Free yourself from all the worries of design, fitting, supervising and taking delivery of your stand: our specialist team at INTERMAT 2012 offers a range of fitted outdoor and indoor stands that are **guaranteed to suit your needs**.  
Add the cost of the fitted stand to the total calculated above

## PAGODA

25 m<sup>2</sup>: €4,134 excl. VAT

50 m<sup>2</sup>: €7,314 excl. VAT

100 m<sup>2</sup>: On request

Illustration/visual for information only



50 m<sup>2</sup>

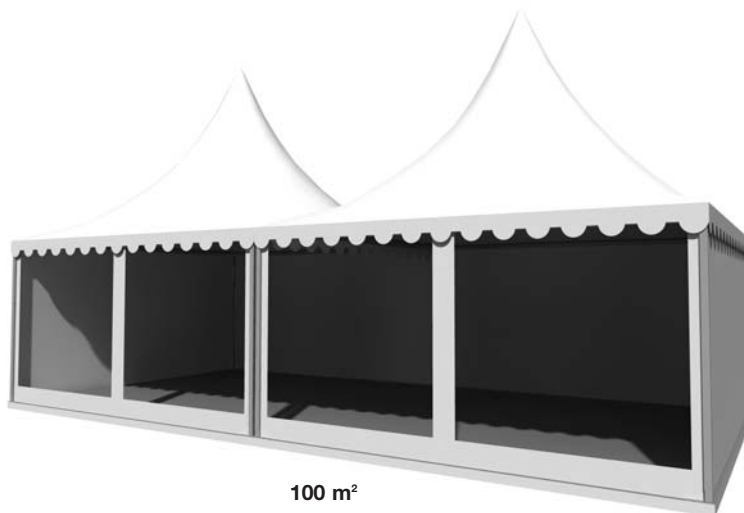

100 m<sup>2</sup>

PAGODA	25 / 50 / 100
Reinforced floor	Yes
Needlefelt carpet (1)	Choice of 5 colours
Interior	Wooden partitioning covered with brushed cotton
Façade	Transparent canopy

(1) red, green, blue, black or grey

## BUNGALOW: 15 m<sup>2</sup>

€4,293 excl. VAT

Illustration/visual for information only

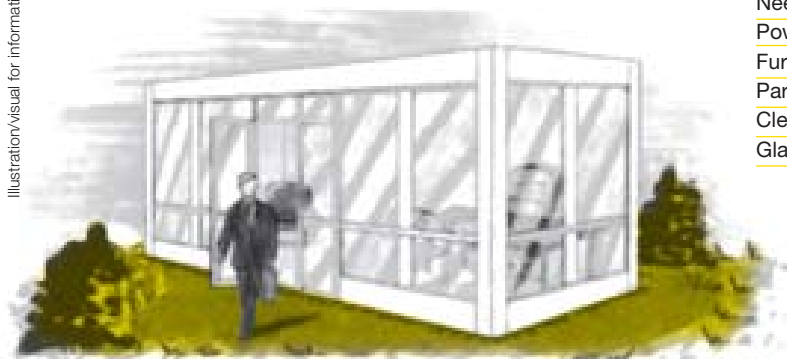

BUNGALOW	15 m <sup>2</sup>
Needlefelt carpet (1)	Choice of 5 colours
Power supply	3 kw
Furniture allowance	€420 excl. VAT
Parking	1 space
Cleaning	Yes
Glazed façade	Yes

(1) red, green, blue, black or grey

# B Indoor Stand

**IMPORTANT:** The only options available for stands of 25 m<sup>2</sup> or under are **BASIC** and **PACK PLUS** see below

## BOOK YOUR STAND SPACE

I wish to apply for a stand of \_\_\_\_\_ m<sup>2</sup>

With the following dimensions if possible: L \_\_\_\_\_ m x W \_\_\_\_\_ m

### 1 YOUR STAND AREA

Calculation for a stand of €1,200 m<sup>2</sup>: (100 m<sup>2</sup> x €183) + (300 m<sup>2</sup> x €158) + (600 m<sup>2</sup> x €129)+(200m<sup>2</sup> x €120)

From 9 to 100 m <sup>2</sup> :	_____ m <sup>2</sup> x <b>€183 excl. VAT</b>	= € _____ excl. VAT	<b>a</b>
From 101 to 400 m <sup>2</sup> :	_____ m <sup>2</sup> x <b>€158 excl. VAT</b>	= € _____ excl. VAT	<b>b</b>
From 401 to 1 000 m <sup>2</sup> :	_____ m <sup>2</sup> x <b>€129 excl. VAT</b>	= € _____ excl. VAT	<b>c</b>
Over 1 001 m <sup>2</sup> :	_____ m <sup>2</sup> x <b>€120 excl. VAT</b>	= € _____ excl. VAT	<b>d</b>
<b>SUBTOTAL (a + b + c + d)</b>		= € _____ excl. VAT	<b>1</b>

### 2 SUPPLEMENT FOR ADDITIONAL OPEN SIDES

Subject to site availability

Stand with  2 open sides: + 12%       3 open sides: + 17%       4 open sides: + 20%

i.e. a supplement of: **1** x \_\_\_\_\_ % = € \_\_\_\_\_ excl. VAT **e**

**SUBTOTAL exhibition space + open side(s): 1 + e** = € \_\_\_\_\_ excl. VAT **2**

Note: Your invoice will show the total amount for the bare stand space taking into account the supplement corresponding to the number of open sides chosen.

### LOYALTY DISCOUNT for exhibitors present in 2009:

Total surface \_\_\_\_\_ m<sup>2</sup> x **€7 excl. VAT** = € \_\_\_\_\_ excl. VAT **f**

**3**  I exhibited in 2009      **2 - f** } = € \_\_\_\_\_ excl. VAT **3**  
 I am a new exhibitor      **2** }

### 4% saving

**SUBTOTAL 3 x 4%** = € \_\_\_\_\_ excl. VAT **g**

On the price of the bare stand space for all exhibitors registering by 29 March 2011 (applications must be postmarked on or before this date)

**4 SUBTOTAL SPACE BOOKED (3 - g) or 3** = € \_\_\_\_\_ excl. VAT **4**

## CHOOSE YOUR STAND PACKAGE

You **must** add the cost of the fitted stand to the total calculated above **4**

I have a stand ≤ 25 m<sup>2</sup>: **BASIC** or **PACK PLUS** option compulsory. Go to **5**

I have a stand > 25 m<sup>2</sup>: Fitting optional, go to **6**

### 5 Stand ≤ 25 m<sup>2</sup>: BASIC or PACK PLUS option compulsory.

(see stand descriptions on page 10)

<input type="checkbox"/> <b>BASIC</b>	_____ m <sup>2</sup> x <b>€50 excl. VAT</b>	= € _____ excl. VAT	
	Optional store cupboard : <input type="checkbox"/> 1 m <sup>2</sup> : <b>€244 excl. VAT</b>	} +€ _____ excl. VAT	
	<input type="checkbox"/> 2 m <sup>2</sup> : <b>€313 excl. VAT</b>		
	<input type="checkbox"/> 4 m <sup>2</sup> : <b>€366 excl. VAT</b>		
		= € _____ excl. VAT	<b>a</b>
<input type="checkbox"/> <b>PACK PLUS</b>	_____ m <sup>2</sup> x <b>€215 excl. VAT</b>	= € _____ excl. VAT	<b>b</b>

**5 SUBTOTAL STAND EQUIPMENT ≤ 25 m<sup>2</sup> (a or b)** = € \_\_\_\_\_ excl. VAT **5**

**6 Stand > 25 m<sup>2</sup>: FITTING OPTIONAL**

**STAND PACKAGES**

**BASIC** \_\_\_\_\_ m<sup>2</sup> x **€50 excl. VAT** = € \_\_\_\_\_ excl. VAT **a**

**PACK PLUS** ≤ 50 m<sup>2</sup> \_\_\_\_\_ m<sup>2</sup> x **€215 excl. VAT** = € \_\_\_\_\_ excl. VAT **b**

> 50 m<sup>2</sup> < 150 m<sup>2</sup> \_\_\_\_\_ m<sup>2</sup> x **€235 excl. VAT** = € \_\_\_\_\_ excl. VAT **c**

**WELCOME PACK**

**New:** tridimensional aluminium framework \_\_\_\_\_ m<sup>2</sup> x **€190 excl. VAT** = € \_\_\_\_\_ excl. VAT **d**

**CUSTOMISED STAND (50 m<sup>2</sup> and over):**

Contact: David Roche +33 (0)1 76 77 15 51

subject to quotation

**ADDITIONAL OPTIONS FOR BARE STAND OR BASIC STAND**

Store cupboard (optional):  1 m<sup>2</sup>: **€244 excl. VAT**

2 m<sup>2</sup>: **€313 excl. VAT**

4 m<sup>2</sup>: **€366 excl. VAT**

} + € \_\_\_\_\_ excl. VAT **e**

Carpet \_\_\_\_\_ m<sup>2</sup> x **€10 excl. VAT** = € \_\_\_\_\_ excl. VAT **f**

3-spotlight track  
(only on ordered partitions): \_\_\_\_\_ No. of tracks x **€45 excl. VAT** = € \_\_\_\_\_ excl. VAT **g**

Partitions \_\_\_\_\_ ml x **€79 excl. VAT** = € \_\_\_\_\_ excl. VAT **h**

**6 SUBTOTAL STAND FITTINGS > 25 m<sup>2</sup>** ( **a** to **h**) = € \_\_\_\_\_ excl. VAT **6**

**7 COMPULSORY CLEANING (only for bare stand)**

Cleaning (€3.50 excl. VAT/m<sup>2</sup>): \_\_\_\_\_ m<sup>2</sup> x **€3.50 excl. VAT** = € \_\_\_\_\_ excl. VAT **7**

**8 Supplement for double-decker stand (only for stands ≥ 200 m<sup>2</sup> at floor level)**

I wish to construct a double-decker stand of \_\_\_\_\_ m<sup>2</sup> x **€91 excl. VAT** = € \_\_\_\_\_ excl. VAT **8**

Any double-decker structure erected on a stand without appropriate notification and payment to the Organiser will be invoiced during the exhibition build-up, with an additional penalty charge of 10% (see article 5 of the Terms and Conditions of Exhibition Space Hire). The area of the double-decker structure must not exceed 50% of the area at floor level and is limited to 300 m<sup>2</sup>.

**B TOTAL INDOOR STAND**

Space booked = € \_\_\_\_\_ excl. VAT **4**

Stand area ≤ 25 m<sup>2</sup> - Fitting compulsory + € \_\_\_\_\_ excl. VAT **5**

Stand area > 25 m<sup>2</sup> - Fitting optional + € \_\_\_\_\_ excl. VAT **6**

Cleaning (compulsory for bare stand) + € \_\_\_\_\_ excl. VAT **7**

Double-decker stand + € \_\_\_\_\_ excl. VAT **8**

**TOTAL INDOOR STAND** = € \_\_\_\_\_ excl. VAT **B**

# Indoor Stand Packages

Free yourself from all the worries of design, fitting, supervising and taking delivery of your stand: our specialist team at INTERMAT 2012 offers a range of fitted stands that are guaranteed to meet your needs. **Add price to the total for the bare stand space.**

## BASIC STAND

INTERMAT provides the basic stand structure, leaving you free to order optional extras – furniture, lighting, etc. – from the Exhibitor's Manual. **Important: this option does not include a junction box.**

BASIC	9 m <sup>2</sup> and over
Aluminium framework	Yes
Melamine partitioning	Yes
Needlefelt carpet (1)	Choice of 5 colours
Spotlights (2)	Yes
Sign with name and stand number (3)	Yes
Cleaning	Yes

- (1) red, green, blue, black or grey  
 (2) 1 x 100W spotlight per 3 m<sup>2</sup> (junction box to be ordered separately)  
 (3) standard lettering, flag-style sign (stand number+ exhibitor name)

€50 excl. VAT/m<sup>2</sup>

Illustration/visual for information only

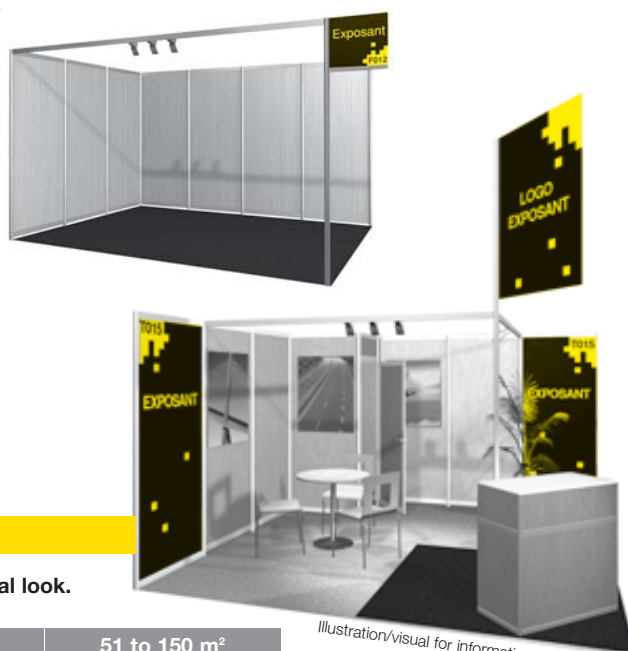

Illustration/visual for information only

## PACK PLUS

Custom design your stand – a range of colours and furniture for an individual look.

PACK PLUS	9 to 50 m <sup>2</sup> €215 excl. VAT/m <sup>2</sup>		51 to 150 m <sup>2</sup> €235 excl. VAT/m <sup>2</sup>
	9 to 25 m <sup>2</sup>	26 to 50 m <sup>2</sup>	51 to 150 m <sup>2</sup>
Aluminium framework (choice of 2 colours)	Yes	Yes	Yes
Melamine partitioning (choice of 2 colours)	Yes	Yes	Yes
Needlefelt carpet (1)	Choice of 5 colours	Choice of 5 colours	Choice of 5 colours
Spotlights (2)	Yes	Yes	Yes
Sign with name and stand number (3)	Yes	Yes	Yes
Power supply (not 24hr)	3 kw	4 kw	6 kw
Furniture	Fixed price: €420 excl. VAT	Fixed price: €780 excl. VAT	Fixed price: €1,300 excl. VAT
Store cupboard with 3 shelves + 1 coat hook	1 m <sup>2</sup>	2 m <sup>2</sup>	4 m <sup>2</sup>
8 m <sup>2</sup> office area	No	No	Yes
Parking spaces	2	3	4
Coffee machine	150 servings	150 servings	300 servings
Tower sign (4)	Yes	Yes	Yes
Refrigerator (5)	140 litres	220 litres	220 litres
Stand cleaning	Yes	Yes	Yes

- (1) red, green, blue, black or grey  
 (2) 1 x 100W spotlight per 3 m<sup>2</sup>  
 (3) standard lettering, flag-style sign (stand number + exhibitor's name)  
 (4) sign printed digitally on two sides with logo  
 (5) supplied without beverages

## WELCOME PACK

A 20 to 60 m<sup>2</sup> hospitality area incorporated into all or part of your stand (e.g. stand of 300 m<sup>2</sup> with 60 m<sup>2</sup> hospitality module covering 20% of your stand area).

€190 excl. VAT/m<sup>2</sup>

PACK WELCOME	20 m <sup>2</sup> to 60 m <sup>2</sup>
TRIDI aluminium framework	Yes
Furniture	Fixed price: €780 excl. VAT
Needlefelt carpet	Choice of 5 colours
300W spotlight (1)	Product and space lighting
Power supply (not 24hr)	3 kw
Sign	4 double sided digitally printed tower signs
Cleaning	Yes

- (1) 1 x 300W spotlight per 9 m<sup>2</sup>

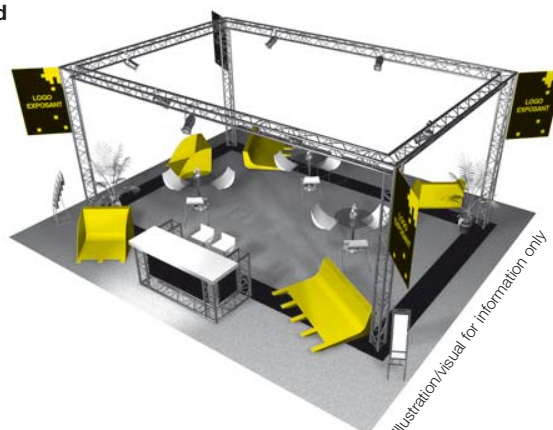

Illustration/visual for information only

## CUSTOMISED STAND (subject to quotation)

Have your stand designed by an expert using a selection of quality materials.

For a study and quotation tailored to your requirements, contact David Roche on +33 (0)1 76 77 15 51 or david.roche@comexposium.com

## C Fixed Costs

### ● REGISTRATION FEE

= €890 excl. VAT **a**

#### Includes:

- administration fee • inclusion in the official exhibition catalogue, with full contact details • use of promotional media • 1 catalogue • 10 exhibitor badges • 1 pigeonhole in the press office • access to the VIP Lounge and press office.

#### Number of free invitations according to stand size

From 9 to 100 m<sup>2</sup> = 4 batches of 100 invitations • From 101 to 500 m<sup>2</sup> = 10 batches of 100 invitations • > 500 m<sup>2</sup> = 60 batches of 100 invitations

#### Please indicate the language(s) you would like for your invitations

French/English = \_\_\_\_\_ x batch(es) of 100 invitations

German/Dutch = \_\_\_\_\_ x batch(es) of 100 invitations

Spanish/Italian = \_\_\_\_\_ x batch(es) of 100 invitations

If we receive no instructions from you, a batch of 100 invitations will automatically be sent in your own language.

### ● INTERNET VISIBILITY PACK

= €110 excl. VAT **b**

Hyperlink + presence in online catalogue and on the interactive map

Address of your website: www. \_\_\_\_\_

### ● STANDARD INSURANCE\*

\* subject to premium increases imposed by the insurance company

Stand < 30 m<sup>2</sup> = €117 excl. VAT or  Stand ≥ 30 m<sup>2</sup> = €230 excl. VAT

= € \_\_\_\_\_ excl. VAT **c**

#### TOTAL FIXED COSTS

**a + b + c**

= € \_\_\_\_\_ excl. VAT **C**

## D Represented Companies Registration

#### Enclose **Appendix 2** "Declaration(s) of Representation"

Including: presentation of equipment, products, services and technology on the applicant's stand + inclusion of company name in the official exhibition catalogue, on the lists of exhibitors and on the website

I wish to represent the following number of companies: \_\_\_\_\_ x €239 excl. VAT

= € \_\_\_\_\_ excl. VAT **D**

## E Online promotional resources (optional)

Your logo\* in the list of exhibitors on www.intermat.fr

€224 excl. VAT

= € \_\_\_\_\_ excl. VAT **a**

Your banner\*\*

€1,800 excl. VAT

= € \_\_\_\_\_ excl. VAT **b**

on one of the 3 most frequently browsed pages of the exhibition website:

List of exhibitors / Badge application / Practical information

Your banner\*\* on the events pages of the exhibition website

€1,600 excl. VAT

= € \_\_\_\_\_ excl. VAT **c**

Intermat Innovation Awards / Pre-Intermat

Your banner\*\* on other pages of the exhibition website

€1,100 excl. VAT

= € \_\_\_\_\_ excl. VAT **d**

#### See the full list of promotional media in Part 2 "Promotion"

\* Comexposium can in no case be held liable for information published on the website with which a hyperlink has been created from the date of publication of the exhibitor list

\*\* Maximum 3 advertisers per rotating banner (every 5 seconds)

#### TOTAL FIXED COSTS

**a to d**

= € \_\_\_\_\_ excl. VAT **E**

## TOTAL FOR YOUR PARTICIPATION

Your stand: **A to B**

= € \_\_\_\_\_ excl. VAT

Fixed costs **C**

+ € \_\_\_\_\_ excl. VAT

Represented companies registration **D**

+ € \_\_\_\_\_ excl. VAT

Online promotional resources **E**

+ € \_\_\_\_\_ excl. VAT

TOTAL excl. VAT

= € \_\_\_\_\_ excl. VAT

(1) Refundable for international exhibitors (in accordance with article 6 of the Terms and Conditions of Exhibition Space Hire). **VAT 19.6%** <sup>(1)</sup>

= € \_\_\_\_\_

TOTAL incl. VAT

= € \_\_\_\_\_ incl. VAT

# Co-exhibitor contract

Name of main stand applicant \_\_\_\_\_

● **REGISTRATION FEE** : see page 11

● **INTERNET VISIBILITY PACK** hyperlink + presence in online catalogue and on the interactive map  
Address of your website: www. \_\_\_\_\_

● **STANDARD INSURANCE\***

+ €890 excl. VAT

+ €110 excl. VAT

+ €117 excl. VAT

**SUBTOTAL CO-EXHIBITOR FIXED COSTS**

= €1,117 excl. VAT **a**

**Option** - Online promotional resources (section **E** page 11)

= € \_\_\_\_\_ excl. VAT **b**

**Represented companies registration**

I wish to represent the following number of companies: \_\_\_\_\_ x €239 excl. VAT

= € \_\_\_\_\_ excl. VAT **c**

Mandatory: enclose **Appendix 2** "Declaration(s) of Representation"

**CO-EXHIBITOR TOTAL**

**TOTAL excl. VAT a + b + c**

= € \_\_\_\_\_ excl. VAT

(1) Refundable for international exhibitors (in accordance with article 6 of the Terms and Conditions of Exhibition Space Hire). **VAT 19.6% (1)**

+ € \_\_\_\_\_

**TOTAL incl. VAT**

= € \_\_\_\_\_ Incl. VAT

## 5 TERMS OF PAYMENT

### Payment of first instalment

Payment of the first instalment must accompany your registration application. In accordance with the Terms and Conditions of Exhibition Space Hire, the entire first instalment is retained by the Organiser in the event of withdrawal or cancellation. An invoice will be sent to you on receipt of your registration application and this sum will be deducted from your final invoice.

In accordance with the Terms and Conditions of Exhibition Space Hire (art. 3),

This application is accompanied by payment of the first instalment as follows: €70 excl. VAT x \_\_\_\_\_  
VAT 19.6%

m<sup>2</sup> = € \_\_\_\_\_ excl. VAT

+ € \_\_\_\_\_

**TOTAL for first instalment (amount excl. VAT + VAT)**

= € \_\_\_\_\_ Incl. VAT

### Balance of your participation

Payable within fifteen days maximum of the invoice date. After 31 December 2011, the total amount is payable at the time of registration. In the event of late payment, the conditions stipulated in article 5 of the Terms and Conditions of Space Rental and Stand Fitting will apply.

### Payment methods

Cheque made payable to: INTERMAT 2012

Bank transfer to: S.E. INTERMAT Immeuble Le Wilson – 70, avenue du Général de Gaulle • 92058 Paris La Défense Cedex - France

Important: You MUST attach the transfer statement to your registration application. Please be sure to arrange with your bank for the name of your company to appear in full on all documents in order to avoid any difficulties in identifying your payment.

The exhibitor is liable for all banking charges relating to the transfer process.

Bank code	Branch code	Account no.	RIB	Account name
30004	00813	000106205/40	51	B.N.P. PARIBAS PARIS ETOILE ENTREPRISES
IBAN (International Bank Account Number) FR76 3000 4008 1300 0106 2054 051				Code BIC (Bank Identifier Code) : BNPAFRPPPGA

### Declaration

I hereby apply to register as an exhibitor at INTERMAT 2012 and declare that I have read and duly noted the "Terms & Conditions of space rental and stand fitting" as well as the exhibition regulations of which I have a copy, and that I accept all clauses unreservedly and will hold the Organiser exempt from any claim.

I hereby declare that I have taken out the necessary insurance policies (with an insurance company known to be solvent) to cover third-party liability for myself and anyone involved directly or indirectly in the exercise of my and/or the company's activities, and to cover bodily injury, physical damage or consequential losses caused to third parties as a result of my and/or the company's participation in INTERMAT 2012 which is due to take place 16-21 April 2012 (including during the build-up and breakdown periods).

Place \_\_\_\_\_ Date \_\_\_\_\_

Name of signatory \_\_\_\_\_ Position of signatory \_\_\_\_\_

Signature preceded by "Read and approved"

Company stamp